



HYATT REGENCY
DUBAI





DESTINATION

Welcome to Dubai, one of the most exciting cities in the world. Ideally located between Europe and Asia, along wonderful beaches of the Arabian Gulf and bordering breath-taking deserts, it is a place where tradition meets modern life.

From ancient history and traditional souks to architectural masterpieces, world-class shopping and the ultimate in luxury, Dubai has all it takes to make it an extraordinary stay.



WELCOME

Experience the legendary warm Arabian hospitality on the historical shores of the Arabian Gulf. Hyatt Regency Dubai combines a sense of tradition with modern conveniences to offer travelers a relaxed stay in the heritage heart of the city.

Offering stunning sea view, the hotel's 421 elegant guestrooms & suites provide a space to work, play or relax in a calm atmosphere. Unique dining options are presented in a warm, energized ambience. Flexible Meetings & Events area and extensive recreational facilities are complemented with an incomparable level of personalized service. Hyatt Regency Dubai is a place for guests to connect with what matters most to them.

SERVICES & FACILITIES

- Complimentary Wi-Fi internet access
- 24-hour in-room dining
- 24-hour Assistant Manager/Concierge
- Group check-in desk
- Club Olympus Spa & Fitness
- Tours and car rental desks
- Airport transfers/limousine for hire
- Safe-deposit boxes at front desk
- Car parking with valet parking facilities and coach drop off
- Multilingual staff
- 24-hour laundry
- Shopping gallery
- Beauty salon, bank, pharmacy and supermarket
- Business Centre with full secretarial facilities
- Doctor on call 24 hours
- Major credit cards accepted

ACCOMMODATIONS

Hyatt Regency Dubai is designed to exceed your every expectation. Relax in the open, energized 421 guestrooms, including 26 suites. Unwind at the Regency Club Lounge offering exclusive privileges. Access the hotel's extensive recreational facilities including an outdoor swimming pool, an ice-skating rink, sun deck, jogging track, tennis courts, pampering treatments and a modern gym at Club Olympus Spa & Fitness. Make the most of being away.

SERVICES & FACILITIES

- 421 spacious guestrooms overlooking the sea and the old city
- Room categories: King & Twin rooms, View rooms, Regency Club rooms, Regency Suites, Regency Executive Suites, Emiri Suites and Royal Suite
- Rooms & suites range from 35 to 280 square meters
- 2 guestrooms are designed for guests with special needs
- Check-in 2:00pm & Check-out 12:00pm

STANDARD AMENITIES

- Large work area with complimentary high-speed Internet access
- Flat screen TVs
- iPod docking station
- Individual air conditioning units
- Complimentary tea-and coffee-making facilities
- Bathrobe and slippers
- Mini-bar
- Electronic safe
- Complimentary access to Club Olympus Spa & Fitness

REGENCY CLUB

The Regency Club offers exclusive services for guests staying in Club Rooms & Suites including privileged access to the Regency Club Lounge offering:

- Daily complimentary Continental breakfast
- Evening cocktails and hors d'oeuvres
- Complimentary Wi-Fi
- Complimentary use of a meeting room (upon request for an hour)
- An outdoor terrace to unwind





RECREATIONAL FACILITIES

Hyatt Regency Dubai proposes extensive recreational facilities to unwind, relax and refresh. Club Olympus Spa & Fitness at the hotel adds an entirely new dimension to the guests' lifestyle, enhancing opportunities to stay fit and in shape as well as to revitalize the balance of body and mind. All spa therapies are customized to the guests' specific requirements taking into consideration their lifestyle and physical condition.

The hotel also features an ice-skating rink with professional instructors.

CLUB OLYMPUS FITNESS

- Gymnasium
- Qualified instructors
- Aerobics studio
- Tennis courts
- Jogging track
- Fitness classes

ICE SKATING RINK

- Figure skating coaching
- Professional trainers
- Fun & safe environment
- Venue for birthday parties, celebrations, team building, school outings & disco nights

POOL

- 15 meters outdoor swimming pool
- Temperature-controlled
- Swimming lessons
- Professional instructors
- Pool bar

CLUB OLYMPUS SPA

- Spa therapies - facials, body treatments & wraps
- Professional therapists
- Whirlpools, steam room & sauna
- Spa Packages
- Sundeck

DINING & ENTERTAINMENT

Choose from a variety of international and traditional cuisines in a warm, energized atmosphere throughout the hotel's famed restaurants and upbeat bars. Our culinary team presents an abundant variety of cuisines from regionally inspired delicacies to on-trend food & beverage offerings.

BARS & LOUNGES

The Bar

An excellent selection of apéritifs, cocktails, wines, beers, spirits and liquors from around the world makes The Bar a favourite hangout for city and hotel residents.

Carpenter's Sports Bar

Carpenter's Sports Bar is a casual, pub-style venue. An ideal place to relax with refreshing drinks with friends while enjoying live entertainment by the resident band.

Hibiki Karaoke Lounge

Hibiki Karaoke Lounge offers guests a chance to sing in front of an audience or in the privacy of one of two themed private rooms, which are fitted with individual, state-of-the-art karaoke units systems.

The Lobby Lounge

Enter the cosmopolitan atmosphere of Dubai, open 24 hours a day, in the Lobby Lounge. Find a rich selection of teas & coffees, cakes and pastries.

Club Olympus Poolside Bar

Enjoy a healthy snack, or simply sip a refreshing cocktail among people who share an enthusiasm for fitness at the Club Olympus Pool Bar.

DeliBites

Enjoy freshly handcrafted delicacies at DeliBites. Try croissants, muffins, sandwiches, wraps, salads, quiches and beverages as you sit by the Ice rink and watch skaters pass by. You can also order a take-away.

RESTAURANTS

Al Dawaar

Experience Al Dawaar, Dubai's only rooftop, revolving restaurant. Combining culinary excellence with spectacular views of the city's skyline, Burj Khalifa, creek and the sea. Enjoy live kitchen dining in a chic, tropical colonial setting.

Miyako

Taste genuine Japanese cuisine in a modern, fresh and moody ambience at Miyako restaurant. The menu takes diners on a culinary journey through delicious Japanese creations. Miyako is divided into three different and authentic dining experiences - a live Teppanyaki room, main dining area with a sushi bar and an intimate Tatami room. A cosy bar offers a wide selection of Sake and Shochu.

The Kitchen

Featuring visually inspiring cuisine, The Kitchen provides a spectacle for those who enjoy watching expert chefs at work in the open show kitchen. Taste a culinary combination of Middle Eastern, Asian and Western food.





WEDDINGS

Be it a lavish wedding or an intimate family gathering, it should be celebrated in style. A pioneer in the local wedding market, with an expertise of over 35 years, Hyatt Regency Dubai is honored to have hosted over 5,000 weddings since its opening.

The hotel features a magnificent Crystal Ballroom which has been reinvented into contemporary luxury and masterfully combines modern style and timeless design. A successful events team offers a menu of superior quality, creative presentation and remarkable discretion, key to accommodating all last-minute changes. Known for exacting standards that emphasize warm hospitality a dedicated team of experts will create unforgettable milestones, to turn your dreams into reality.

WEDDINGS & SOCIAL GATHERINGS

- The magnificent Crystal Ballroom spells chic sophistication and features a luxurious 1,188 Sq. M of space masterfully combining modern style and timeless design.
- An ideal venue to host a lavish wedding or social gathering coupled with an incomparable level of personalised service for up to 1000 guests.
- A spacious pre-function area offering natural light and a separate entrance.
- Creatively presented menus by experienced chefs, customised to your needs.
- An attached bridal suite specially created for the bride's easy access to the ballroom and privileged use.

LAYLATI

Add a special touch of Emirati culture with local signature food items from Laylati, our authentic Emirati Kitchen. Laylati can prepare a feast for groups of ten to more than 1,500 people.

Specially commissioned equipment is available to facilitate door-to-door delivery to private homes or chosen venues using specially designed hot holding cabinets and full-service equipment.

OFFSITE EVENTS

- The Outside Events Team can assist with planning an event at an outdoor location be it a home, an office or any other venue.
- Tailormade menus crafted by experienced chefs for the event.
- Impeccable service with warm hospitality offered.



MEETINGS &
EVENTS

MEETINGS & EVENTS SPACE

Conveying modern sophistication, Hyatt Regency Dubai offers 4000 Sq. M. of flexible Meetings & Events space. Conveniently located near the business district and major attractions in the city, the hotel is an ideal venue for business or social events in luxurious surroundings with an incomparable level of personalized service.



MEETINGS & EVENTS

Welcome to endless possibilities for hosting Meetings & Events at Hyatt Regency Dubai. Presenting 4000 Sq. M. of sophisticated and flexible Meetings & Events space coupled with an incomparable level of personalized service. Attendees can re-energize with customized food & beverage offerings by creative chefs, while the organizers can experience smooth planning and hassle-free preparation by professionals. A perfect venue to host a conference, an exhibition, a product launch or a spectacular gala dinner.

CRYSTAL BALLROOM

- Masterfully combines modern style and timeless design
- Features 1,188 Sq. M of space
- Crystal Ballroom can host up to 1,000 guests
- High resolution AV apparatus, 4 big screens
- Latest Bose sound system (concert style) and ability to program lights to different colors
- Spacious pre-function area offers sea view, a perfect place for coffee breaks by creative chefs

AL MARKAZ

- A contemporary and unique high-end business enclave
- Six meeting suites
- Meeting spaces can host from 10 to 150 guests
- Equipped with the latest technology and smart layouts
- Ideal for professionals, meetings, events and social gatherings
- Variety of settings-natural daylight, views over the Arabian Gulf



MEETING SUITES

- 17 Meeting & Exhibition suites that offer flexible space
- Meeting Suites which can host from 10 to 500 persons
- Suites feature latest technology and innovative facilities
- Personalized service offered
- Variety of settings -natural daylight, views over the Arabian Gulf, etc.
- Creatively presented menus by experienced chefs

CAPACITY CHART
Lobby Level & Outdoor



Room Name	Room Dimensions L x W x H	Sq. Ft. Meters	Banquet	Reception	Theater	Classroom	Boardroom	U-Shape	Hallow Square	Exhibit
CRYSTAL BALLROOM	107' x 116' x 21' 33m x 36m x 6m	12,412 1,188	800	1000	1000	700	120	150	180	—
Section A	79' x 62' x 21' 24m x 19m x 6m	4,898 456	350	500	450	330	96	126	156	—
Section B	79' x 42' x 21' 24m x 13m x 6m	3,318 312	200	300	250	160	76	88	100	—
Section C	101' x 36' x 9' 31m x 11m x 3m	3,636 341	250	350	300	160	86	92	98	—
CRYSTAL FOYER	82' x 29' x 9' 25m x 9m x 3m	2,378 225	—	250	—	—	—	—	—	—
REGENCY ROOM	55' x 29' x 9' 17m x 9m x 3m	1,595 153	60	70	90	72	30	33	36	—
REGENCY FOYER	55' x 22' x 9' 17m x 7m x 3m	1,210 119	—	120	—	—	—	—	—	—
SAPPHIRE	39' x 13' x 9' 12m x 4m x 3m	507 48	30	30	25	18	20	—	—	—
JADE/ OPAL / TOPAZ	49' x 22' x 9' 15m x 7m x 3m	1,078 105	50	70	80	54	36	39	42	—
Jade	16' x 22' x 9' 5m x 7m x 3m	352 35	10	15	25	18	10	12	15	—
Opal	16' x 22' x 9' 5m x 7m x 3m	352 35	10	15	25	18	10	12	15	—
Topaz	16' x 22' x 9' 5m x 7m x 3m	352 35	10	15	20	12	10	12	15	—
EMERALD	26' x 22' x 9' 8m x 7m x 3m	572 56	40	35	40	18	18	21	24	—
BRIDAL ROOM	16' x 22' x 9' 5m x 7m x 3m	352 35	—	—	—	—	—	—	—	—

FLOOR PLAN
Lobby Level

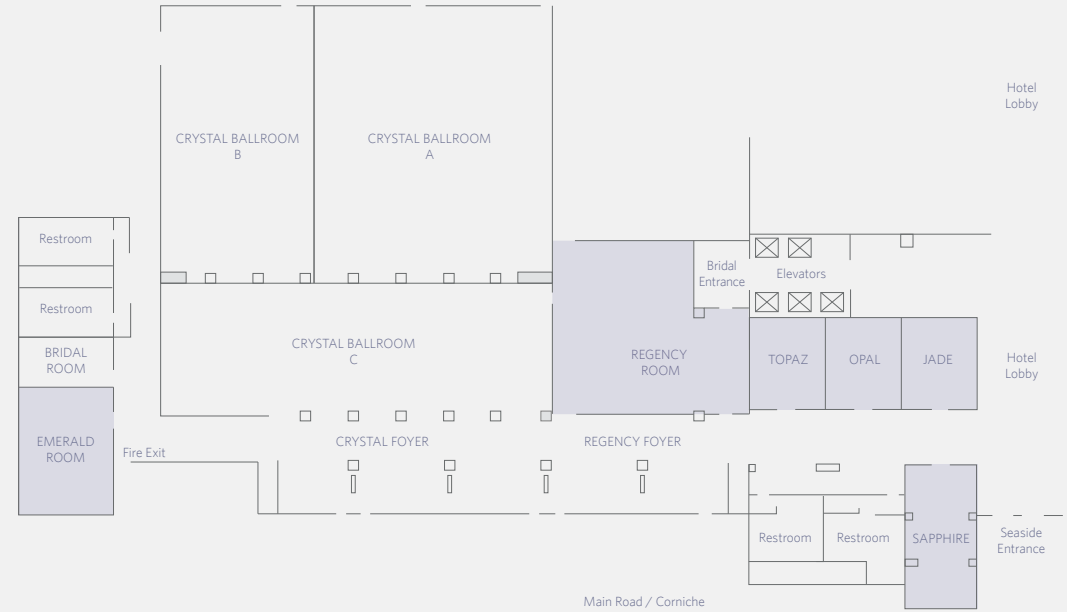

CAPACITY CHART
Mezzanine Level & Second Level



Room Name	Room Dimensions L x W x H	Sq. Ft. Meters	Banquet	Reception	Theater	Classroom	Boardroom	U-Shape	Hallow Square	Exhibit
SAMEEM 1	13' x 18' x 8' 4m x 5m x 2.5m	234 20	8	—	—	—	—	—	—	—
SAMEEM 2	13' x 18' x 8' 4m x 5m x 2.5m	234 20	8	—	—	—	—	—	—	—
JAWHAR 1	24' x 24' x 8' 7m x 7m x 2.5m	576 49	40	—	40	24	18	20	22	—
JAWHAR 2	24' x 24' x 8' 7m x 7m x 2.5m	576 49	40	—	40	24	18	20	22	—
MEWHAR	44' x 21' x 8' 13m x 6m x 2.5m	924 78	80	60	75	60	30	34	38	—
Mewhar 1	21' x 22' x 8' 6m x 6m x 2.5m	462 36	30	—	35	24	10	12	16	—
Mewhar 2	21' x 22' x 8' 6m x 6m x 2.5m	462 36	30	—	35	24	10	12	16	—
PEARL	84' x 19' x 9' 26m x 6m x 3m	1,596 156	100	120	120	80	60	64	68	—
Pearl 1	23' x 19' x 9' 7m x 6m x 3m	437 42	30	30	30	18	12	14	16	—
Pearl 2	28' x 19' x 9' 8m x 6m x 3m	516 48	30	30	30	18	12	14	16	—
Pearl 3	34' x 19' x 9' 10m x 6m x 3m	646 60	40	30	30	24	20	24	26	—
DIAMOND	88' x 17.9' x 14.4' 27.4m x 5.6m x 4.5m	1,575 154	100	120	120	80	60	64	68	—
Diamond 1	44' x 17.9' x 14.4' 13.7m x 5.6m x 4.5m	787 77	50	60	60	40	30	32	34	—
Diamond 2	44' x 17.9' x 14.4' 13.7m x 5.6m x 4.5m	787 77	50	60	60	40	30	32	34	—

FLOOR PLAN
Mezzanine Level
Al Markaz

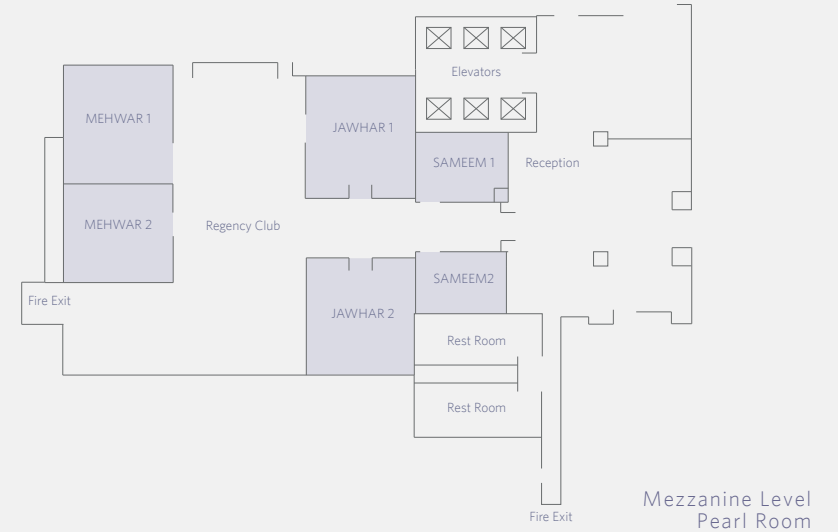

Mezzanine Level
Pearl Room

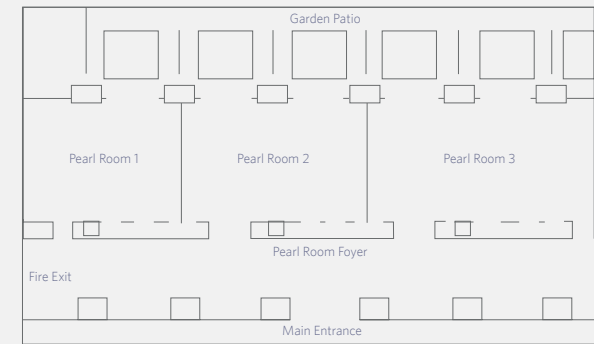

Second Level
Diamond Room

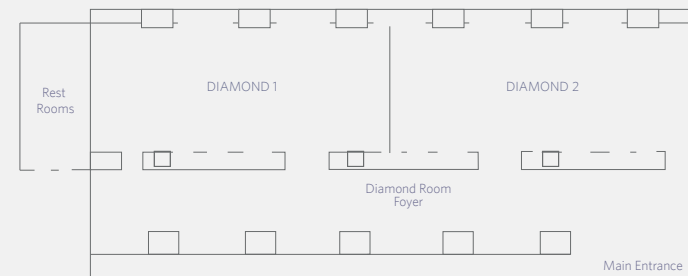

ACCOMMODATIONS

Dubai International Airport (DXB)	12 km
Dubai International Convention Centre	08 km
Emirate of Sharjah	25 km
Dubai Creek	08 km
Deira City Centre	03 km
Burjuman Centre	09 km
The Mall of Emirates	22 km
The Dubai Mall	15 km
Jebel Ali Free Zone	34 km
Al Mamzar Beach	7 km
Jumeirah Beach	13 km
Gold Souk, Spice Souk, Textile Souk	Less than 1 km

VISITOR INFORMATION

Language: Arabic, English is widely spoken and understood.

Electricity: 220/230 volts AC

Currency: United Arab Emirates Dirham (AED)

Climate: Sub-tropical, arid climate and sunny blue skies

Visas: These may be arranged by the hotel (a minimum of five working days prior to arrival) and are required by all persons entering the country with the exception of citizens from certain countries.

For a full list of exceptions, please consult our website hyattregencydubai.com or check with your local UAE embassy.





HYATT
REGENCY™

HYATT REGENCY DUBAI
P.O. Box 5588 Dubai, UAE
T +971 4 209 1234
hyattregencydubai.com